

UNIVERSAL JOINTS

PIN AND BLOCK TYPE STEEL AND STAINLESS STEEL

J/JS SERIES BORED AND SOLID HUBS

STANDARD TOLERANCES

Dimensions		Tolerance	
		Steel	Stainless
Bore	All	± .001	±.001
Hub Dia.	All	+ .000 - .003	±.020
Bore Length	All	±1/16	±1/64
Overall Length	1-3/4 - 4-1/4	±1/64	±1/64
	5 - 10-5/8	±1/32	±1/32

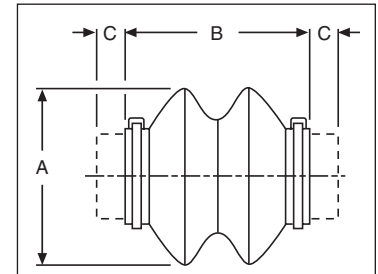
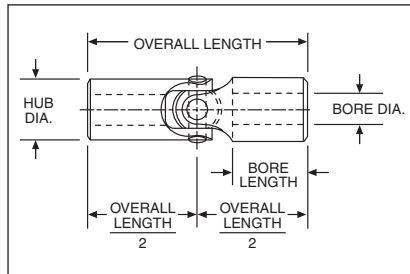

Boot Kit

REFERENCE PAGES

Lubrication—148
Mounting—148

ALL DIMENSIONS IN INCHES
ORDER BY CATALOG NUMBER OR ITEM CODE

Universal Joints										Boot Kits†					
STEEL		STAINLESS STEEL		Bore**	Bore* Length	Hub Dia.	Overall Length	Keyway	Setscrew	Approx. Weight Lbs.	A	B	C	Catalog Number†	Item Code
Catalog Number	Item Code	Catalog Number	Item Code												
J37A-3/16	72467	-	-	3/16	11/16	3/8	1-3/4	-	2-56NC	.04	1-1/32	1-1/32	9/32	UB37	47602
J37B	08426	JS37B	08472												
J37	08400	JS37	08452												
J50A-1/4	72468	-	-	1/4	3/4	1/2	2	-	4-40NC	.08	1-1/4	1-5/16	11/32	UB50	47603
J50B	08428	JS50B	08474												
J50	08402	JS50	08454												
J62A-5/16	72469	-	-	5/16	13/16	5/8	2-1/4	3/32x3/64	10-32NF	.14	1-1/2	1-7/16	13/16	UB62	47604
J62B	08430	JS62B	08476												
J62	08404	JS62	08456												
J75A-3/8	72470	-	-	3/8	31/32	3/4	2-11/16	3/32x3/64	10-32NF	.24	1-3/4	1-9/16	9/16	UB75	47605
J75B	08432	JS75B	08478												
J75	08406	JS75	08458												
J87A-7/16	72471	-	-	7/16	1-1/32	7/8	3	3/32x3/64	10-32NF	.31	2	1-13/16	19/32	UB87	47606
J87B	08434	JS87B	08480												
J87	08408	JS87	08460												
J100A-1/2	72472	-	-	1/2	1-3/16	1	3-3/8	1/8x1/16	1/4-20NC	.50	2-1/4	2-1/8	5/8	UB100	47607
J100B	08436	JS100B	08482												
J100	08410	JS100	08462												
J112A-9/16	72473	-	-	9/16	1-7/32	1-1/8	3-1/2	1/8x1/16	1/4-20NC	.69	2-9/16	2-7/16	17/32	UB112	72491
J112B	72474	JS112B	72483												
J112	72475	JS112	72484												
J125A-5/8	72476	-	-	5/8	1-1/4	1-1/4	3-3/4	3/16x3/32	5/16-18NC	.88	2-7/8	2-3/4	1/2	UB125	47608
J125B	08438	JS125B	08484												
J125	08412	JS125	08464												
J150A-3/4	72477	-	-	3/4	1-11/32	1-1/2	4-1/4	3/16x3/32	5/16-18NC	1.44	3-1/4	3-1/4	1/2	UB150	47609
J150B	08440	JS150B	08486												
J150	08414	JS150	08466												
J175A-7/8	72478	-	-	7/8	1-9/16	1-3/4	5	3/16x3/32	5/16-18NC	2.31	3-5/8	3-3/4	5/8	UB175	47610
J175B	08442	JS175B	08488												
J175	08416	JS175	08468												
J200A-1	72479	-	-	1	1-5/8	2	5-7/16	1/4x1/8	3/8-16NC	3.31	4-1/2	4-3/16	5/8	UB200	47611
J200B	08444	JS200B	08490												
J200	08418	JS200	08470												
J250A-1-1/4	72480	-	-	1-1/4	2-3/32	2-1/2	7	1/4x1/8	3/8-16NC	6.81	5-1/2	4-7/8	1-1/16	UB250	47612
J250B	08446	JS250B	72485												
J250	08420	JS250	72486												
J300A-1-1/2	72481	-	-	1-1/2	2-27/32	3	9	3/8x3/16	1/2-13NC	12.5	6	5-5/8	1-11/16	UB300	47613
J300B	08448	JS300B	72487												
J300	08422	JS300	72488												
J400A-2	72482	-	-	2	3-1/8	4	10-5/8	1/2x1/4	1/2-13NC	25.8	6-7/8	6-5/8	2	UB400	47614
J400B	08450	JS400B	72489												
J400	08424	JS400	72490												

*Approximate Hub Projection

†Each Kit contains (2) Boots and (4) Ties together with complete instructions for installation and lubrication.

**Style A includes bore, keyway and setscrew. Style B includes bore only